



JOHNSTON COUNTY ENVIRONMENTAL HEALTH DEPARTMENT

205 South Second Street
Smithfield, North Carolina 27577
Telephone (919) 989-5180

IMPROVEMENT PERMIT

Application No.: 32131

Name: FSA HOMES Tax Map No.: _____

Address: _____ Date: 4 MAY 94

Location: VIRGINIA DOWNS 3/0 - SR1003

S/D Lot No.: 65

Facility: PRIVATE RESIDENCE

No. Bedrooms: 3 Design Daily Sewage Flow: 360 Lot Area: 1.02 AC

New Construction: YES Repair: N/A Water Supply: PRIVATE

Soil/Site Classification: PS

Septic Tank Size: 900 Grease Trap Size: N/A

Pump Tank Size: 1000 GAL ONE PIECE Pump(s) Size: To Pump 30-30 GPM @ 30' TDH

Drainfield Type: CONVENTIONAL Square Feet: 750

No. Lines: 2 Width: 36" Length: 120 Depth: 18-20"

Design/Layout by: _____ Permit Issued By: RICHTER

Inspection: Lines: _____ Septic Tank/Box: _____

Pump Tank: _____ Pump(s)/Pressure: _____

Drainage: _____ Contractor: BRANTON

Certificate of Completion By: [Signature] Date: 2 AUG 94

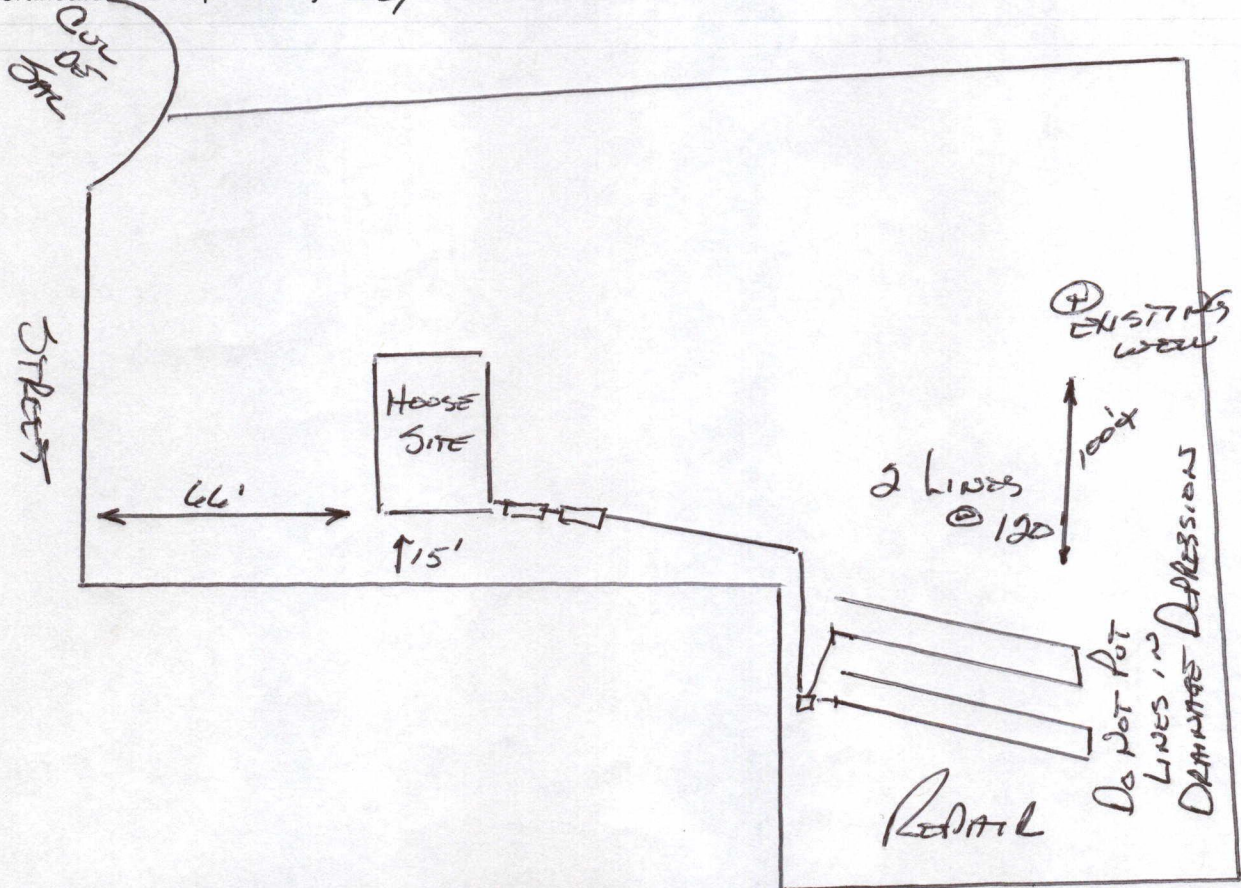

Systems shall be installed as shown in sketch or as on attached plans and specifications. Any unauthorized site disturbance, filling, soil removal, or layout changes may result in this permit being revoked. This permit is good for 5 years from date of issue.