

FLOORPLAN SKETCH

Borrower:	File No.: 193697
Property Address: 302 JONES AVENUE	Case No.:
City: HILLSBOROUGH	State: NC
Lender: STEPHANIE CORNETTE/ REMAX ONE REALTY	Zip: 27713

APPROXIMATE DIMENSIONS
DRAWING NOT TO SCALE

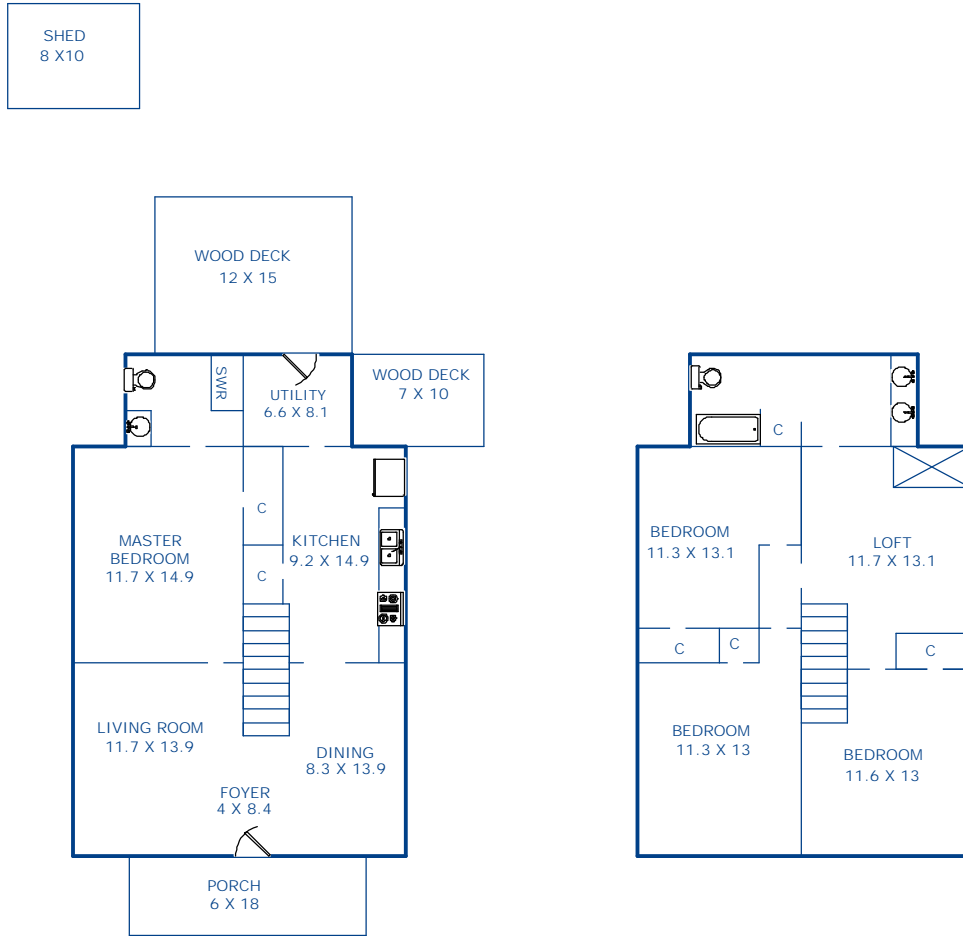

THIS MEASUREMENT IS COPYRIGHTED TO MCNAMARA & COMPANY AND THE CLIENTS LISTED IN THE HEADER OF THIS SKETCH NO ONE ELSE MAY USE

Sketch by Apex Sketch v5 Standard™

Comments:

AREA CALCULATIONS SUMMARY			
Code	Description	Net Size	Net Totals
GLA1	First Floor	910.46	910.46
GLA2	Second Floor	910.46	910.46
Net LIVABLE Area		(rounded)	1821

LIVING AREA BREAKDOWN			
Breakdown		Subtotals	
First Floor			
31.2	x	25.3	789.36
7.0	x	17.3	121.10
Second Floor			
25.3	x	31.2	789.36
7.0	x	17.3	121.10
4 Items		(rounded)	1821